

**INSTALLATION REQUIREMENTS**

- I. THE FLOOR UNDER THE DOOR MUST BE LEVEL AND SMOOTH
- II. THE WALL BEHIND THE DOOR FRAME MUST BE SMOOTH AND IN A COMMON PLANE

**DOOR PANEL AND FRAME**

1. DOOR THICKNESS <sup>4"</sup>
2. TEMPERATURES
  - COOLER
  - FREEZER
3. SWING
  - LEFT
  - RIGHT
4. PANEL AND FRAME CLADDING
  - WHITE STUCCO EMBOSSED GALV STEEL
5. LATCH
  - PADLOCKABLE
  - CHROME FINISH
6. INTERIOR RELEASE
  - SAFETY RELEASE W/ NYLON PUSH ROD
7. HINGE
  - CHROME FINISH
8. FASTENERS
  - THROUGH BOLTS
9. JAMBS
  - JAMB DEPTH 3 1/2"
  - JAMB DEPTH 5 1/2"

**OPTIONS**

10. INSIDE PLASTIC TRIM
11. FREEZER DOOR HEATER WIRE RUN THROUGH 3 SIDES OF DOOR FRAME AS WELL AS THRESHOLD

**4' X 6'-6" DOOR**

NOTE: LEFT SWING SHOWN, RIGHT SWING OPPOSITE

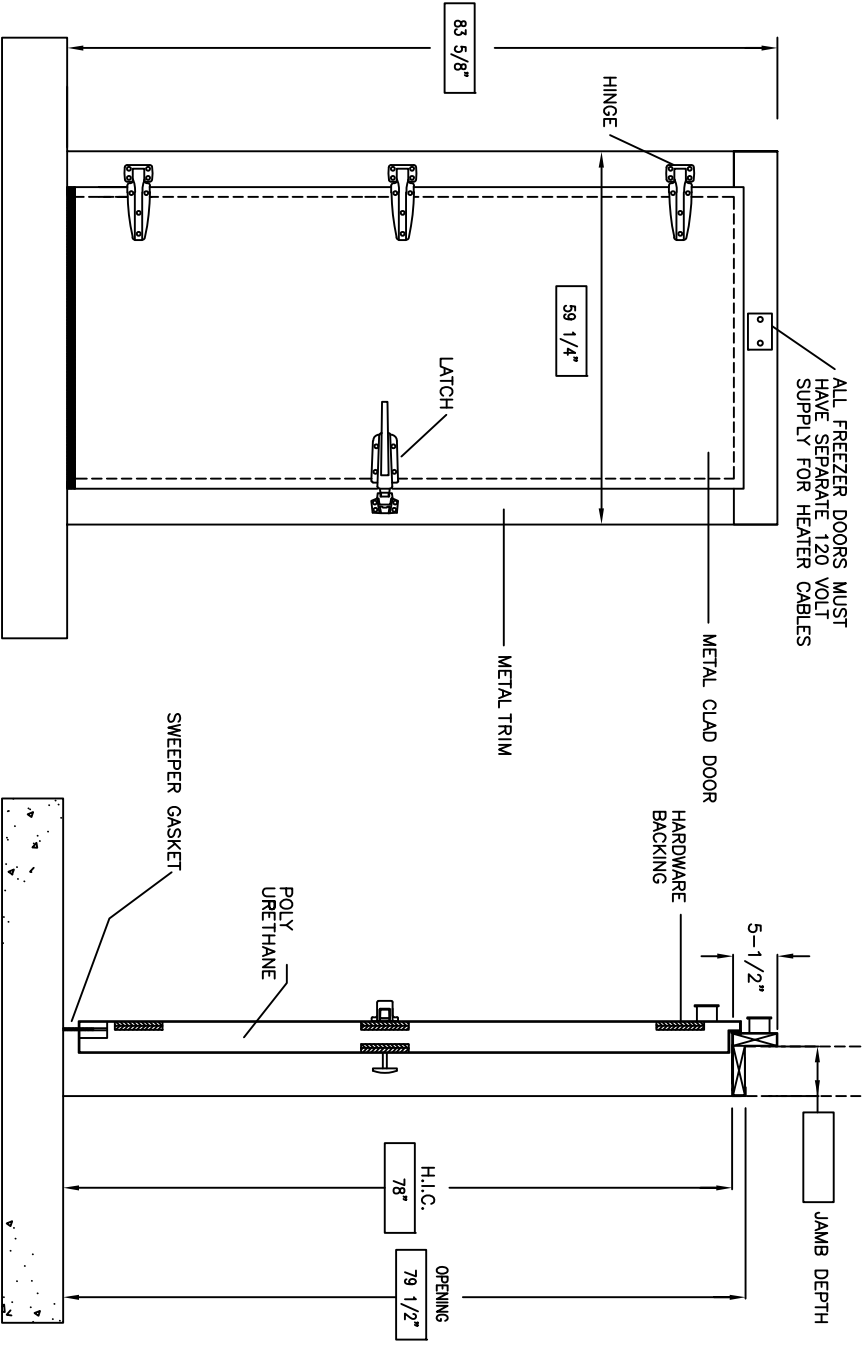

**920-231-1711**  
**WWW.BARRINC.COM**  
**WALK-IN COOLER OR**  
**FREEZER DOOR**