

Notes:

Wall panels #1, 2, 3, 4, 5, 11, 12, 17, 18, 19 are 5½" thick.

Wall panels #6 thru #16 are 3½" thick.

11'7" x 15'7" x 8' H
L-Shape Cooler/ Freezer With Floor
Wall Panels Diagram

7-2019
Color code: No color
Not drawn to scale.

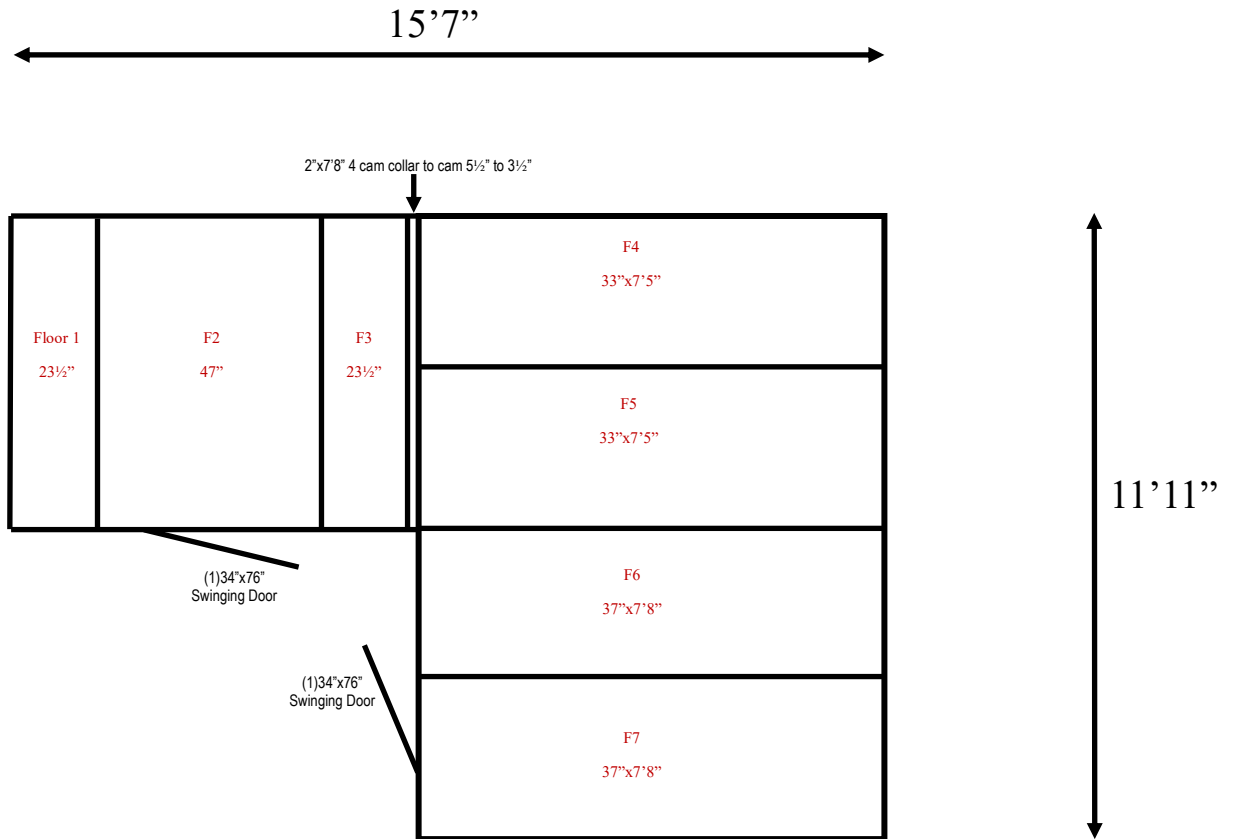

Notes:

- F1, F2, F3 are 5½" thick panels.
- F4, F5 are 33"x7'5" & 3½" thick panels.
- F6, F7 are 37"x7'8" & are 3½" thick panels.

11'7" x 15'7" x 8' H
L-Shape Cooler/ Freezer With Floor
Floor Panels Diagram

7-2019
Color code: No color
Not drawn to scale.

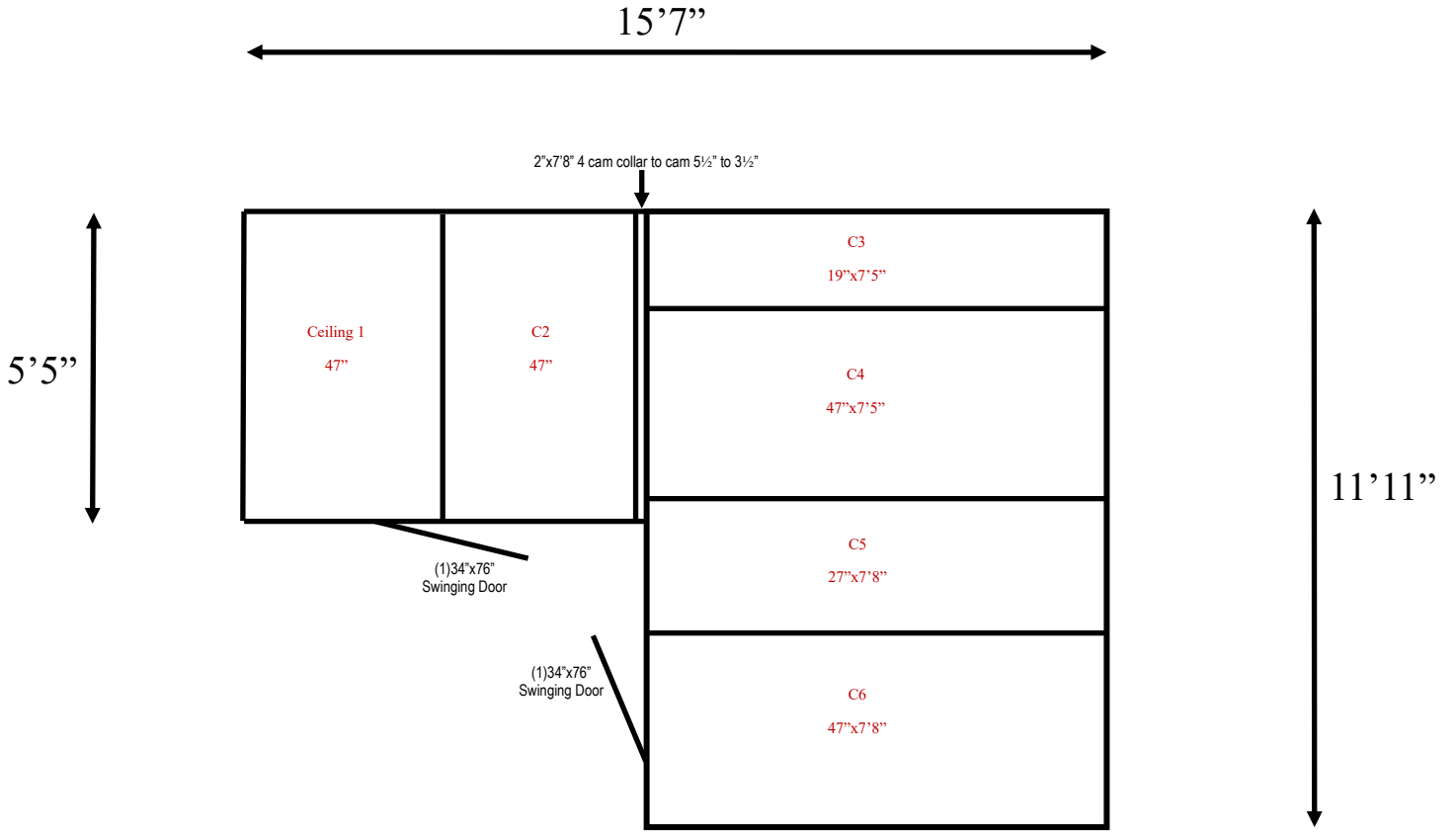

Notes:

C1, C2 are 5½" thick panels.

C3, C4, C5, C6 are 3½" thick panels.

11'7" x 15'7" x 8' H
L-Shape Cooler/ Freezer With Floor
Ceiling Panels Diagram

7-2019
Color code: No color
Not drawn to scale.

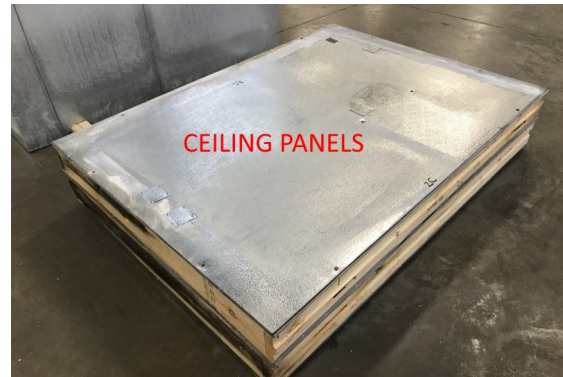

11'7" x 15'7" x 8' H
L-Shape Cooler/ Freezer With Floor

7-2019
No color



11'7" x 15'7" x 8' H
L-Shape Cooler/ Freezer With Floor

7-2019
No color