

INSTALLATION REQUIREMENTS

- I. THE FLOOR UNDER THE DOOR MUST BE LEVEL AND SMOOTH
- II. THE WALL BEHIND THE DOOR FRAME MUST BE SMOOTH AND IN A COMMON PLANE

DOOR PANEL AND FRAME

1. DOOR THICKNESS ^{4"}
 2. TEMPERATURES
COOLER
FREEZER
 3. SWING
LEFT
RIGHT
 4. PANEL AND FRAME CLADDING
WHITE STUCCO EMBOSSED GALV STEEL
 5. LATCH
PADLOCKABLE
CHROME FINISH
 6. INTERIOR RELEASE
SAFETY RELEASE W/ NYLON PUSH ROD
 7. HINGE
CHROME FINISH
 8. FASTENERS
THROUGH BOLTS
 9. JAMBS
JAMB DEPTH 3 1/2"
JAMB DEPTH 5 1/2"
- OPTIONS**
10. INSIDE PLASTIC TRIM
 11. FREEZER DOOR HEATER WIRE RUN THROUGH 3 SIDES OF DOOR FRAME AS WELL AS THRESHOLD

3' X 7' DOOR

NOTE: LEFT SWING SHOWN, RIGHT SWING OPPOSITE

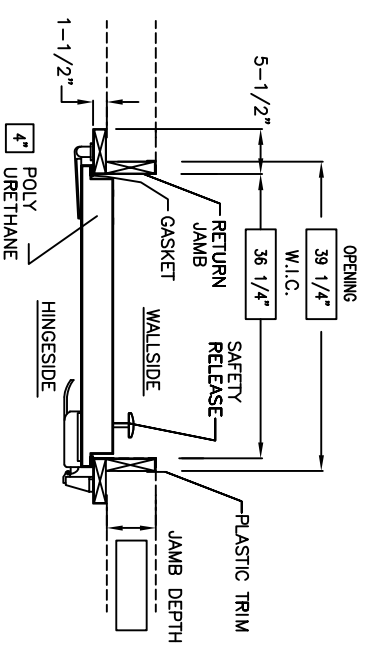
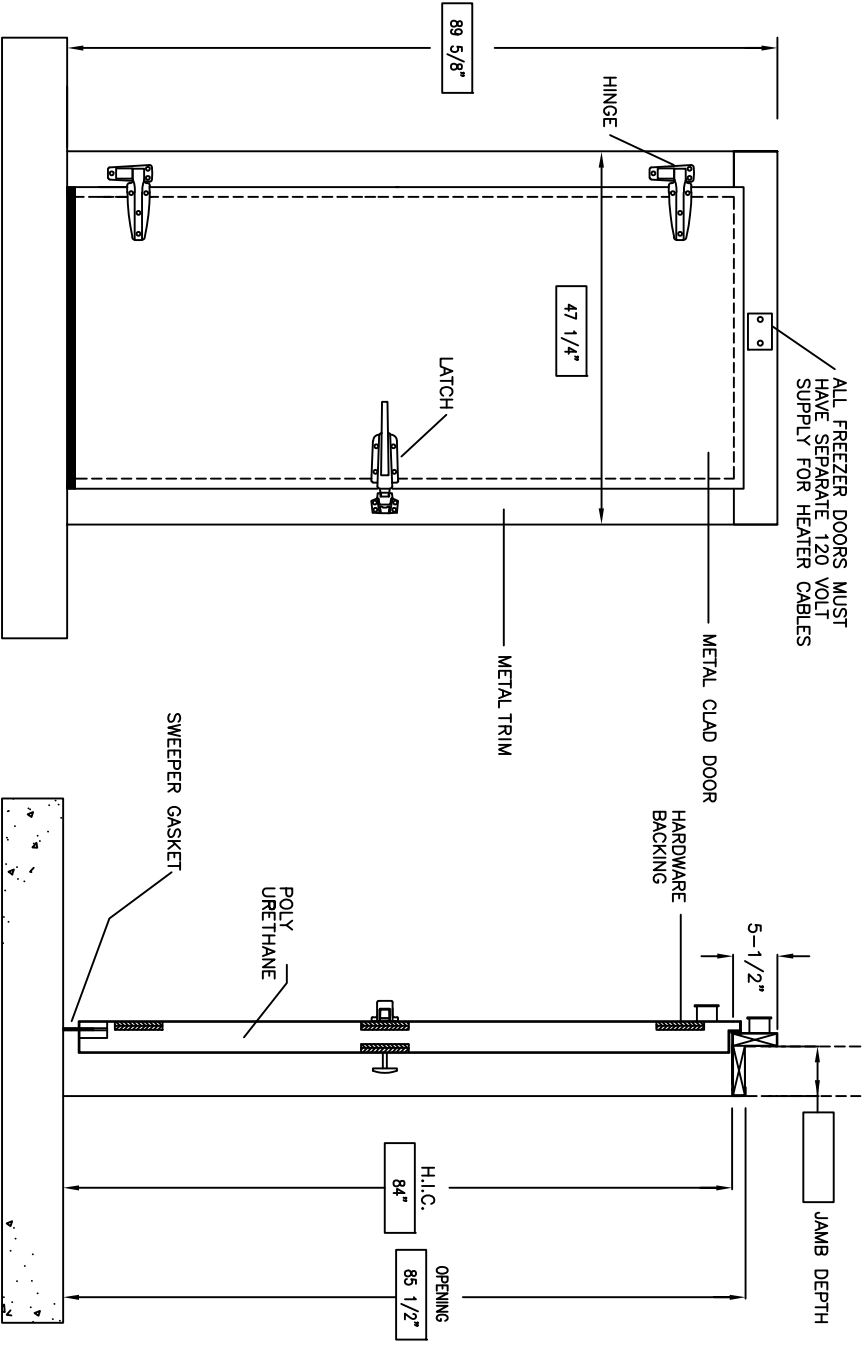

920-231-1711
WWW.BARRINC.COM
WALK-IN COOLER OR
FREEZER DOOR